

Central Brass Company, Inc.
3325 S. Garfield Ave.
Commerce, CA 90040
(800) 321-8630
www.centralbrass.com

Model Number: 0364, 0365 Series

Warnings and Notes:

Check with local plumbing code requirements before installation.
This product should be installed by a local listed plumber.
Do not use plumbers putty on threads.

Installation Steps:

Drinking Faucet

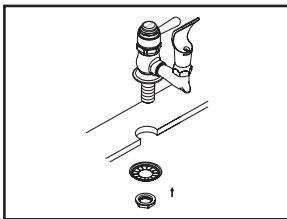

(1) Apply a layer of plumbers putty to underside of the faucet, place faucet shank through the mounting hole. Slide the crowfoot washer through the shank from underneath of the sink. Tighten the locknut to secure the faucet with the help of a 1-3/32" socket.

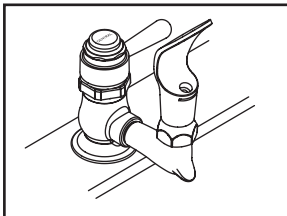

(2) Connect water supply line to the faucet shank.

INSTALLATION

Tools:



Socket



Plumbers Putty



Teflon Tape



Rags

