

13636BFSC TTR – ACCESSIBLE SHOWERS

Interior: 36 x 36 x 76 ¾
Exterior: 42 x 38 ½ x 78 ¾
inches

The 13636BFSC TTR transfer shower features innovative installation design, including an engineered leveled base and improved front threshold with molded integral linear trench drain. A true time and money saver, our pre-leveled base lets you install directly on a **level** floor. And its front threshold is engineered to keep a constant level with the innovative nailing flange.



Shown fully-equipped

AQUATIC ADVANTAGE

- National distribution
- 6 manufacturing facilities
- Private fleet
- Centralized customer service
- Field support

COLOR & TRIM OPTIONS

Stock	Upgraded
-------	----------

White	Biscuit Bone
-------	-----------------

**Additional custom colors available.
(Contact Customer Service)

FEATURES

- Pre-leveled base
- AcrylX™ applied acrylic surface
- 1 ⅛" skirt
- Barrier free when properly installed
- Smooth large subway tile wall
- Center front drain outlet
- Integral front trench drain
- Lifetime Limited Warranty Residential Use/30-year Commercial Use

OPTIONS

- Grab bars
- Fold-up seat
- Hand-held shower assembly with slide bar
- Pressure balancing mixing valve
- Large soap dish
- Small soap dish
- Curtain rod and/or shower curtain
- Tamper-proof grate

CODE COMPLIANCE

- ADA
- FHA
- ICC/ANSI A117.1
- HUD UM73a
- CSA B45.5-11 / IAPMO Z124-2011

**Code compliant when fully equipped and installed according to guidelines.



Aquatic products may be specified as Lasco Bathware.



Interior: 36 x 36 x 76 ¾
Exterior: 42 x 38 ¼ x 78 ¾
inches

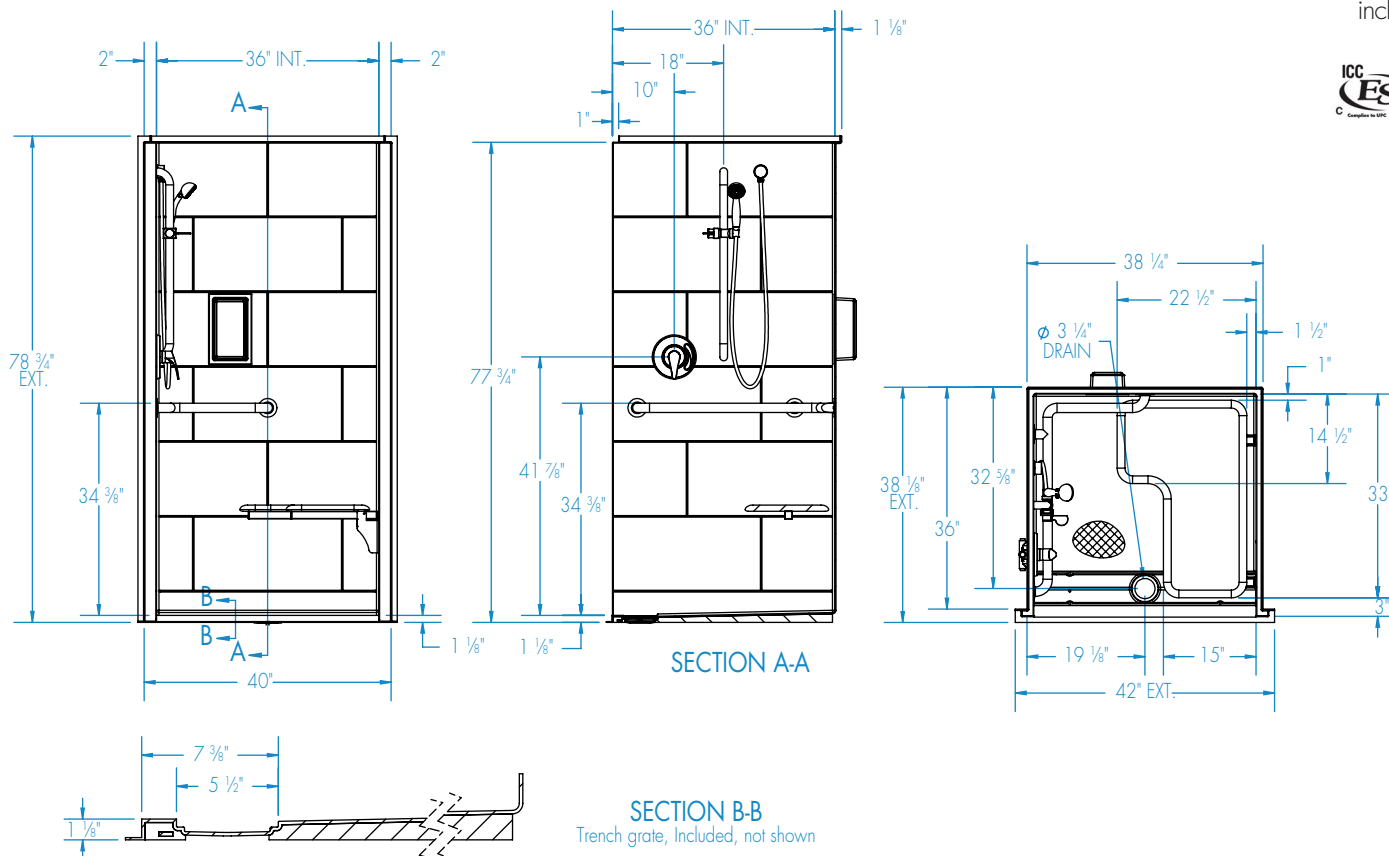

FEATURES

Dimensional Tolerance ± 3/8". Dimensions needed for site preparation should be measured from the unit. Manufacturer assumes no responsibility for preparatory work.

Type and Model #	Material	Wall Finish	Pieces	Drain	Dam/Skirt Height	Net Wt. lbs	Pkg. Wt. lbs
Shower 13636BFSCTTR	AcrylXTM applied acrylic	Smooth tile	1	Center Front	1 ½" skirt	140	150

DIMENSIONS

Specifications	inches
Width: Ext. / Int.	42 / 36
Depth: Ext. / Int.	38 ¼ / 36
Height: Ext. / Int.	78 ¾ / 76 ¾
Enclosure Opening:	36
Skirt Height:	1 ½
Drain Rough-In (from Back Wall)	32 ¾
Drain Rough-In (from Side Wall)	19 ¼

FRAMING DIMENSIONS inches

Type	D Depth	W Width	H Height	A	B	C
Alcove	36	38 ¼	-	Box Out	19 ¼	32 ¾

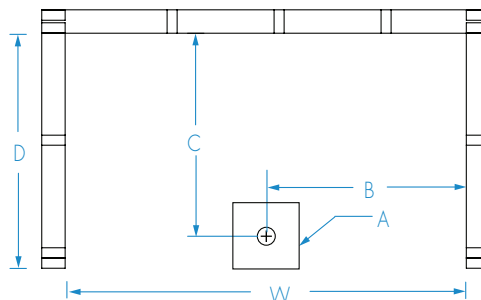

Aquatic products may be specified as Lasco Bathware.